

钱江工业机器人

QJRH4-1A

INDUSTRIAL ROBOT



工博士网: www.gongboshi.com
 官网: www.gongboshi.org
 邮箱: service@gongboshi.com
 电话: 021-31666777



- 该款主要用于弧焊焊接，具有高可靠性和优异的性价比。其特点如下：
- 采用中空型结构手臂、手腕，焊接电缆内置，可在狭窄空间焊接作业，重量轻便，结构紧凑；
- 通过安装机身盖罩，可以放心使用于各种恶劣的环境（防尘和防滴）；
- 工作空间大、运行速度快、重复定位精度高，适用于对焊缝质量有较高要求的焊接应用。
- The robot is mainly used for arc welding, with high reliability and excellent value for money. Its features are as follows:
- Hollow structural arms and wrists, built-in welding cable, able to operate welding procedure in narrow space, lightweight, compact structure.
- By installing protective cover, you can rest assured that it can be used in a variety of harsh environments (dust and drip).
- Large workspace, fast running speed, high repeat positioning accuracy, suitable for quality demanding welding applications.

机器人外形尺寸和最大动作范围图

Figure Of Robot Shape Size And Maximum Motion Range

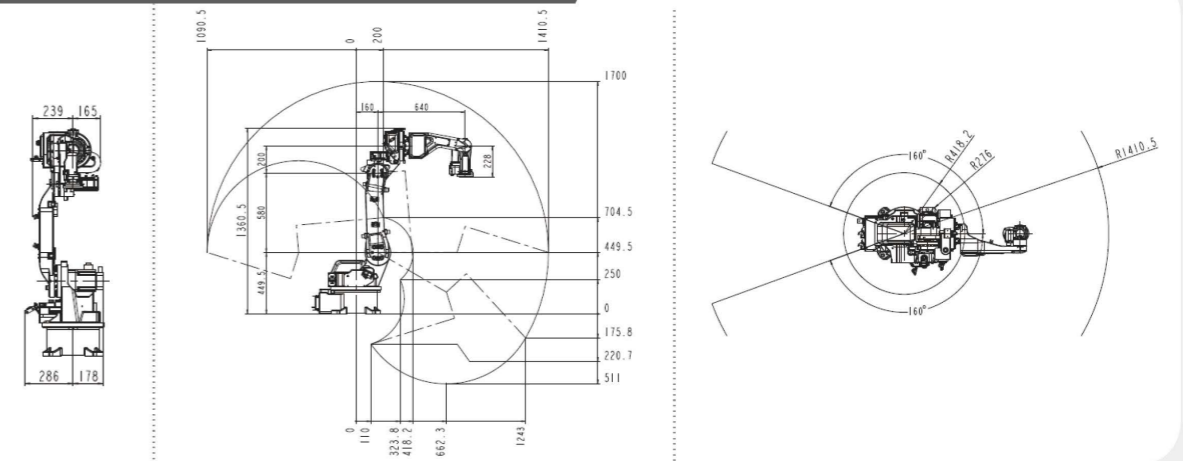

机器人末端安装尺寸图

Dimension Chart Of Robot End - Mounted

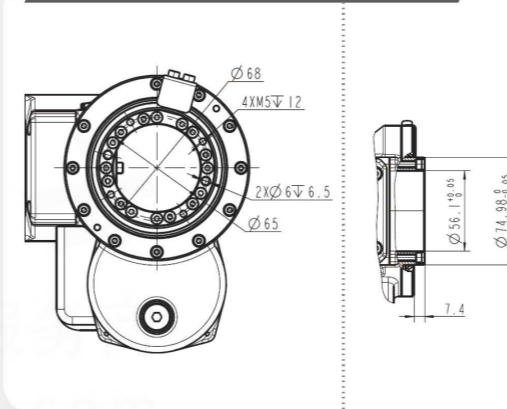

机器人底座安装尺寸图

Mounting Dimensions Of Robot Base

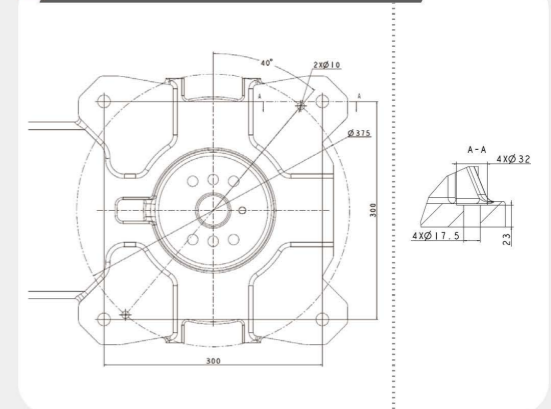

机器人基本规格表

Technical Specifications Of Robot

机构形态 Mechanism	垂直多关节 Vertical multi-joint robot	允许扭矩 Allowable Torque	J4 10.51 N·m J5 10.51 N·m J6 2.94 N·m
轴数 Axis Number	6	惯性力矩 Inertia Moment	J4 0.38 kg·m ² J5 0.38 kg·m ² J6 0.03 kg·m ²
有效载荷 Payload	4kg	安装环境 Installation Environment	温度 TEMP 0~45 °C 湿度 HUM 20%~80% RH (不结露) Nocondensation
重复定位精度 Repeat Positioning	±0.05mm	振动 NVH	< 4.9m/s ² (0.5G)
最大臂展 Max Armspan	1410.5mm	其他 Others	避免易燃、腐蚀性气体和液体； Avoid flammable, corrosive gases and liquids; 避免接触水、油、粉尘等； Avoid contact with water, oil, dust, etc.;
防护等级 Protection Degree	IP30	电源容量 Power Capacity	2.7kVA
本体重量 Robot Body Weight	150kg	电控柜尺寸 Cabinet Size	580*600*960mm
机械限位范围 Motion Range	J1 ±168° J2 +150°, -89° J3 +85°, -111° J4 ±167° J5 +58°, -217° J6 ±360°	电控柜重量 Cabinet Weight	130kg
最大速度 Max Speed	J1 201°/s J2 201°/s J3 235°/s J4 350°/s J5 355°/s J6 481°/s	电源 Source	三相四线380V ^{±10%} -10%
		安装方式 Installation	地面、吊顶 Wall, Ceiling